



Specifications

Light Source: 1x300W LED
Color Temperature: 8000K
Zoom Angle: 7°~31°

Features

Motorized linear zoom system with wash effect, zoom range: 7°~31°
Motorized focus
Color Wheel: 2 color wheels, both of them has 7 colors plus open
Gobo Wheel: 1 static gobo wheel with 10 gobos plus open; 1 rotating gobo wheel with 7 gobos plus open, easy to replace
Gobo's outer diameter: 26.8mm
Gobo's inner diameter: 20mm
1 linear iris
Prism: 8 facet prism rotating in both directions
Various strobe speeds

ENERGY SPOT KA-400 SPOT

Control

DMX Channel: 19/22 channels
Control Mode: DMX512
Firmware Upgrade: Update via DMX link

Pan/Tilt

Pan/Tilt: 540°/ 260°
Pan/Tilt Resolution: 16 bit

Construction

Display: LCD display
Data In/Out: 3-pin XLR
Power In/Out: PowerCon in
Protection Rating: IP20

Electrical and Physical

Power Voltage: AC 100~240V, 50/60Hz
Power Consumption: 383W
Dimensions: 430x254x674mm
Weight: 21kg

Photometrics Diagram

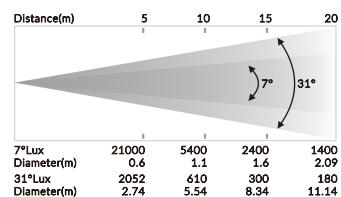

Dimensions(mm)

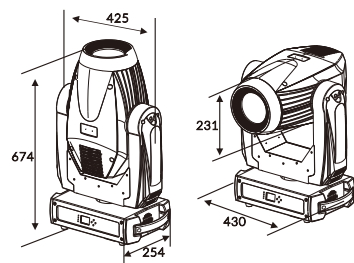

Color/Gobo Wheel

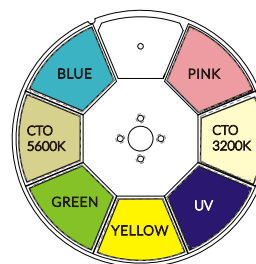

Color Wheel 1

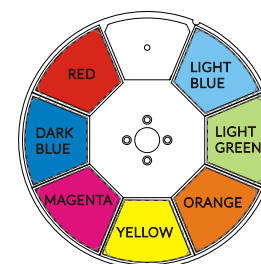

Color Wheel 2

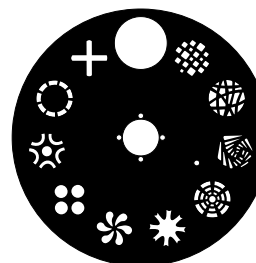

Static Gobo Wheel

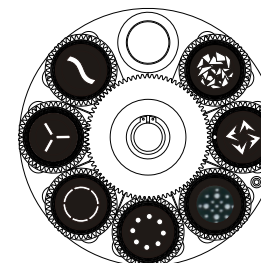

Rotating Gobo Wheel