



ELLIPSOIDAL E-300

Specifications

Light Sources: 1 x 280W cool/warm white LED
Color Temperature: 3100±150K/5600±200K

Control

DMX Channel: 1/2/2D Channels
Control Modes: DMX, Master/slave, manual dimming
Firmware Upgrade: Update via DMX link

Construction

Display: LCD display
Data In/Out: 3-pin & 5-pin XLR
Power In/Out: PowerCon in/out
Protection Rating: IP20

Optical

CRI: WW≥90, CW≥85
CQS: WW≥91, CW≥88
TLCI: WW≥94, CW≥90

Photometrics Diagram

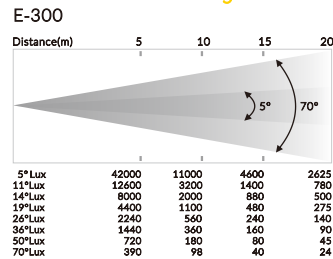

Dimensions(mm)

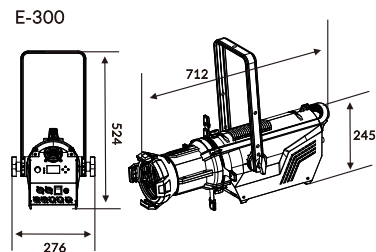

Effects

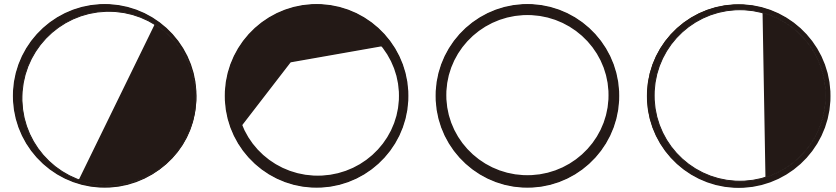

Photometrics Diagram

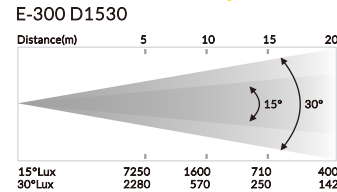

Dimensions(mm)

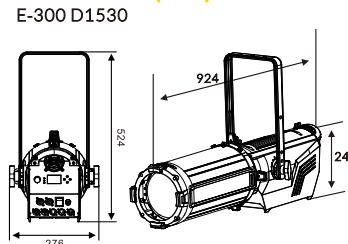

E-300 D1530

Photometrics Diagram

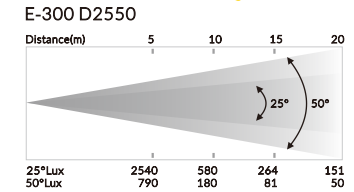

Dimensions(mm)

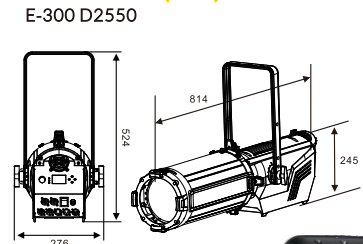

E-300 D2550



E-300

Features

Lens Options: 5°/11°/14°/19°/26°/36°/50°/70° (E-300)
Framing module 1: for beam angle 5°/11°/14°/19°/26° (E-300)
Framing module 2: for beam angle 36°/50°/70° (E-300)
15°~30° manual smooth focus (E-300 D1530)
25°~50° manual smooth focus (E-300 D2550)
Excellent smooth light output
Standard beam shaping shutters & a gobo slot
0~100% linear dimming
With strobe effect and gradients effect
Excellent thermal design, long lifespan for LED
Low noise under 25dB @1m

Electrical and Physical

Power Voltage: AC 100~240V, 50/60Hz
Power Consumption: 335W
Dimensions(mm): 712x276x245mm, 10Kg (E-300)
924x276x245mm, 14.5Kg (E-300 D1530)
814x276x245mm, 13.8Kg (E-300 D2550)
Dimensions(in): 28.0"x10.8"x9.6" in, 22.0lbs (E-300)
36.3"x10.8"x9.6" in, 31.9lbs (E-300 D1530)
32.0"x10.8"x9.6" in, 30.4lbs (E-300 D2550)