



Specifications

Light Source: 1 x 440W LED
Color Temperature: 7500K
Beam Angle: 14°~35°
Luminous Flux: 12000lm

Features

Linear CMY color mixing
Linear CTO color correction
Color Wheel: 1 color wheel with 6 colors plus open
Gobo Wheel: 1 static gobo wheel with 8 gobos plus open
1 rotating gobo wheel with 6 gobos plus open, easy to replace
Gobo's outside diameter: 37.3 mm
Gobo's image diameter: 27 mm
3 facet prism+5 facet linear prism,
both of them can rotate in both directions
Motorized linear iris
4 fast and smooth framing shutters,
each shutter blade position and angle can
be controlled individually; complete
framing module can be rotated at 180°
Various strobe speeds

GEIST FRAMING XA-500 FRAMING

Control

DMX Channel: 29 / 31 channels
Control Mode: DMX512, RDM
Firmware Upgrade: Update via DMX link

Pan/Tilt

Pan/Tilt: 540°/ 270°
Pan/Tilt Resolution: 16 bit
Fixation: Tilt lock

Construction

Display: LCD display
Battery backup for user operation without
connecting to the mains
Data In/Out: 3-pin and 5-pin XLR
Power In/Out: PowerCon in
Protection Rating: IP20

Electrical and Physical

Power Voltage: AC 100~240V, 50/60Hz
Power Consumption: 650W
Dimensions(mm): 447x265x720mm
Dimensions(in): 15.7"x10.4"x28.3" in, 70.5lbs

Photometrics Diagram

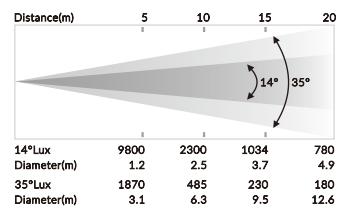

Dimensions(mm)

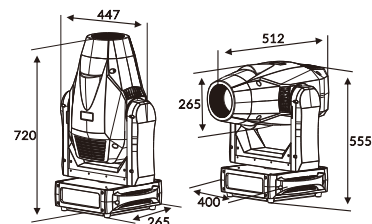

CMY+CTO/Color/Gobo Wheel

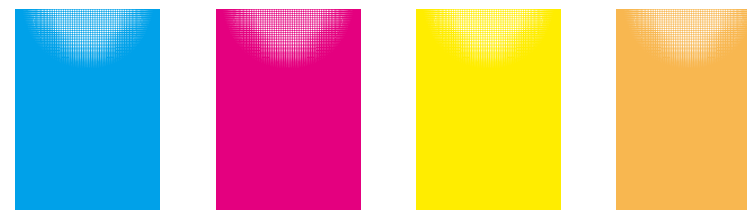

CMY+CTO

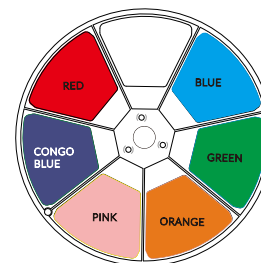

Color Wheel

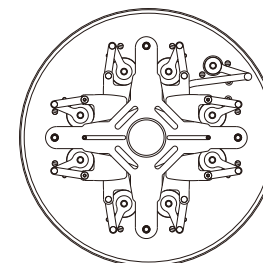

Framing Module

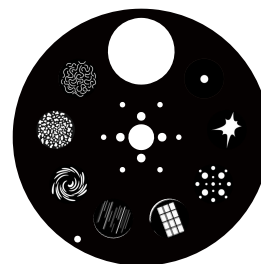

Static Gobo Wheel

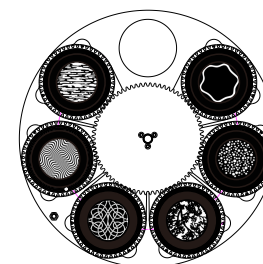

Rotating Gobo Wheel