

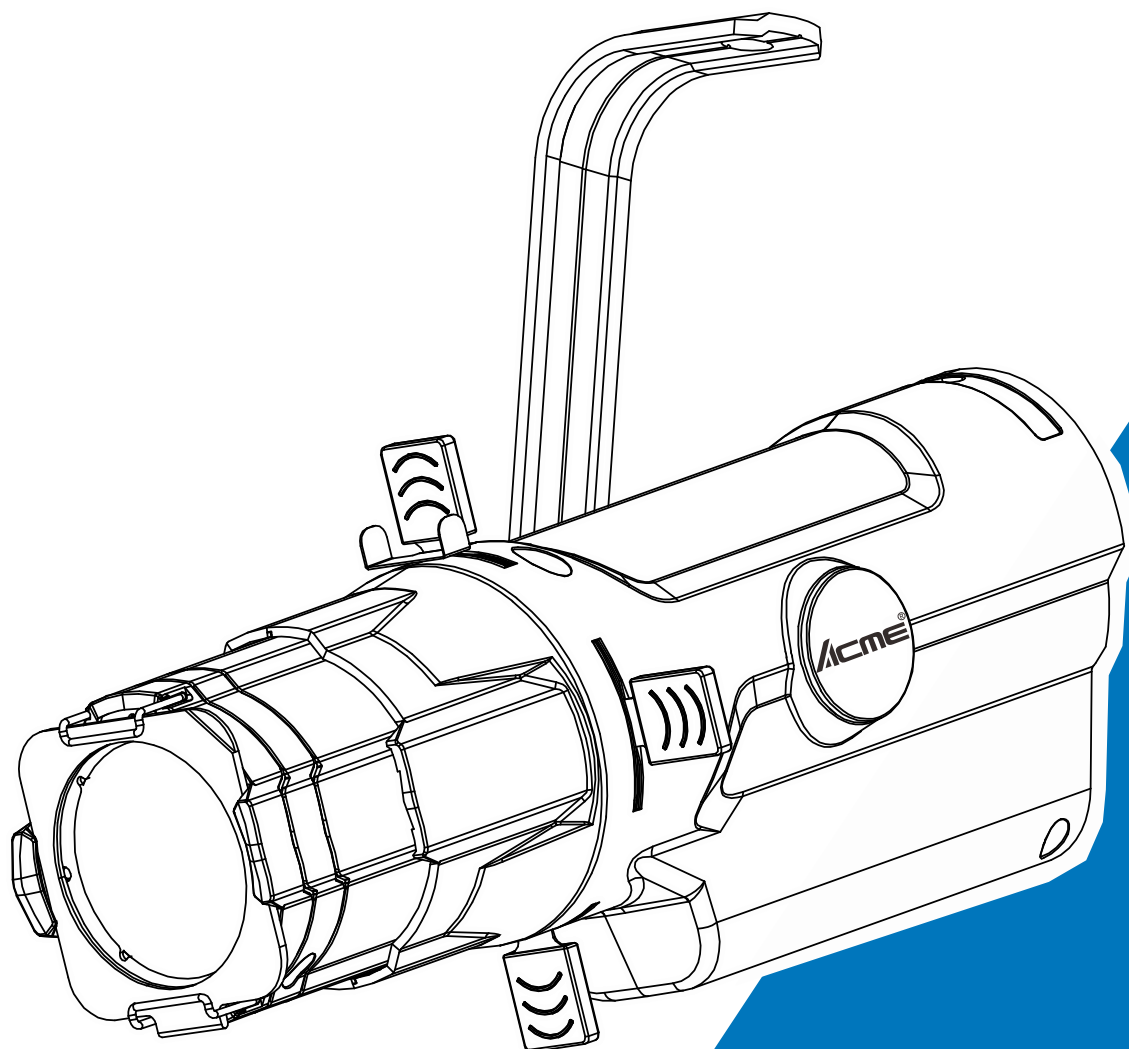

Mini Ellipsoidal 10
Mini Ellipsoidal 40



User Manual

Please read the instruction carefully before use

Specifications:

◇ **Power Voltage:**

AC 85~127V, 50/60Hz

AC 175~264V, 50/60Hz

◇ **Power Consumption: 15W (E-10)**

30W (E-40)

◇ **Light Source:**

E-10 CW DXX: LTAW1202-012-007-5500

E-10 WW DXX: LTAW1202-012-007-3150

E-40 CW DXX: C117C1206-036-001

E-40 WW DXX: C117W1206-036-001

◇ **Color temperature: CW(5600K±150K)/WW(3200K±150K) (optional)**

◇ **Beam Angle: 19°/26°/36°/50°**

◇ **CRI≥95**

◇ **Dimension/Weight: 273x128x194mm, 1.3kgs**

10.7"x5"x7.6" in, 2.9lbs

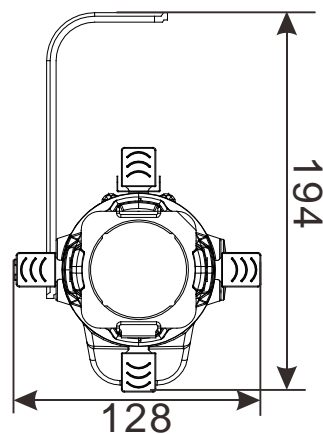
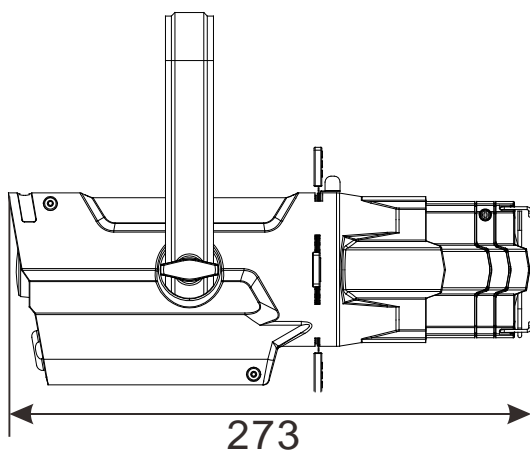

Photometric diagram:

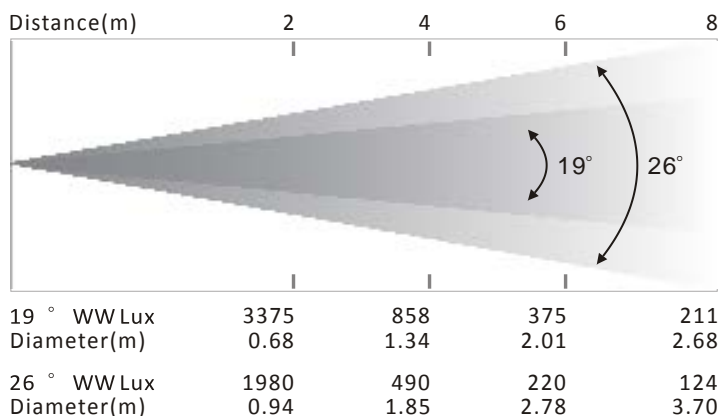

Change The Gobo

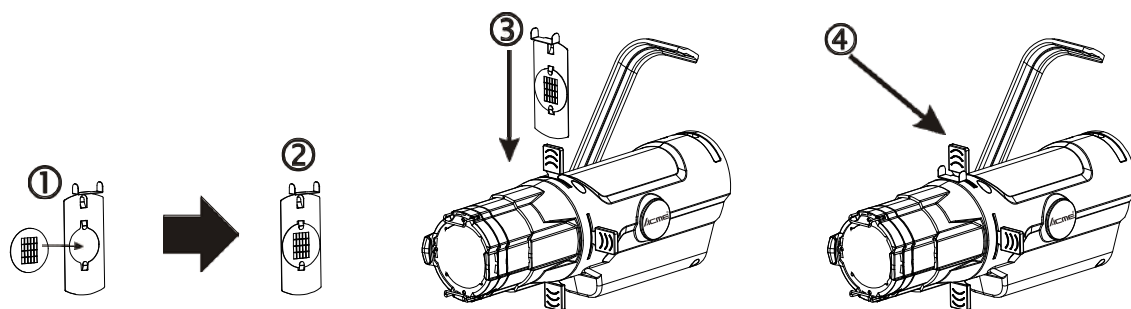

At first, put the gobo by hand as the arrow into the gobo gel splint, and insert the gobo gel splint into the slot of the unit, please turn the hand knob to left or right in order to take out gobo gel splint.

Note: The diameter of the inner and outer rings of the gobo, the size and thickness of the gobo gel splint are shown in the following figure:

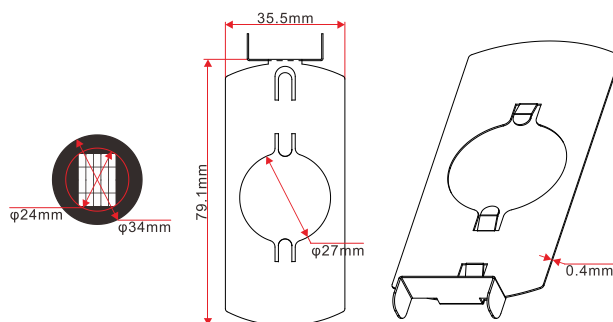

The Color Gel Splint Installation

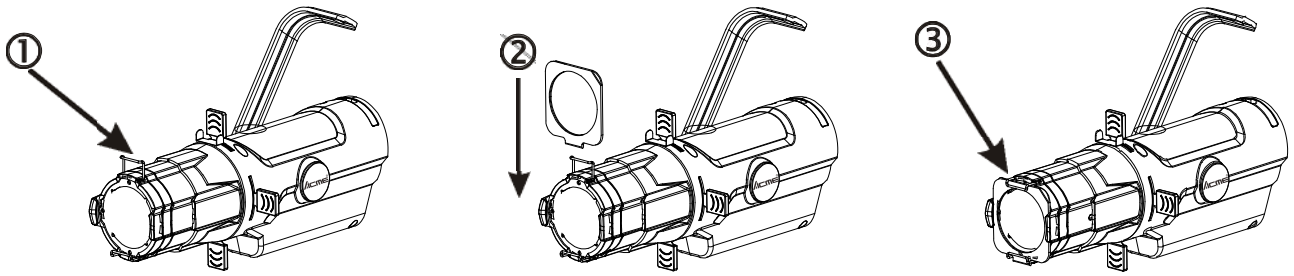

At first, please push the Lock Cap button by hand as the arrow, and move away the Lock as the arrow, then insert the color gel splint into the inside slot from topside, and fasten the lock.

Installation

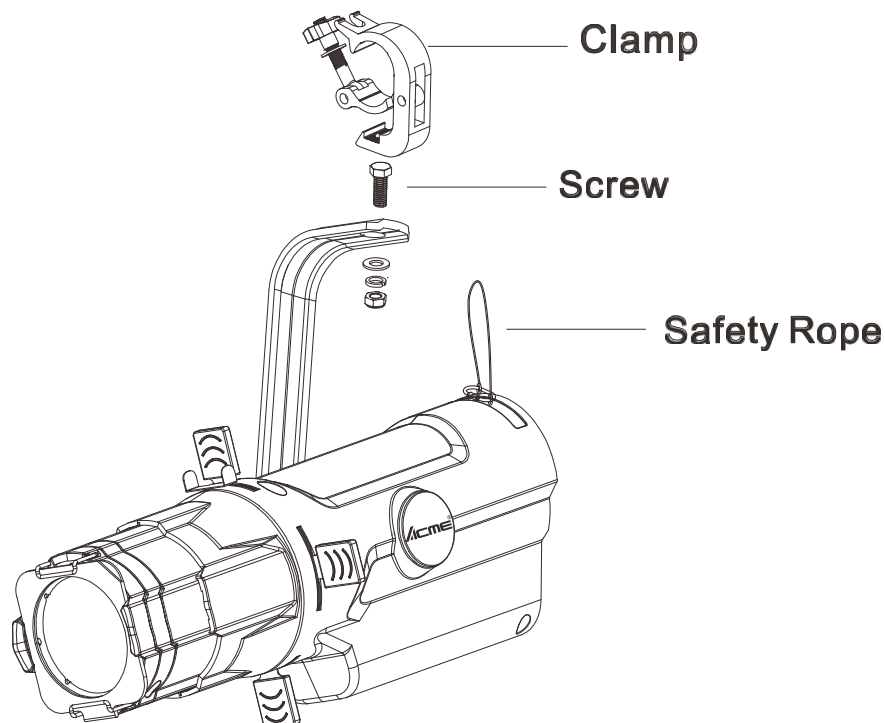

Screw the clamp to the bracket via the screw and nut. Pull the safety-rope through the fixture and over the trussing system or a safe fixation spot.

Troubleshooting

The fixture does not work, no light

1. Check the connection of power and main fuse.
2. Measure the mains voltage on the main connector.

Fixture Cleansing

The cleaning of internal and external optical lenses and/or mirrors must be carried out periodically to optimize light output. Cleaning frequency depends on the environment in which the fixture operates: damp, smoky or particularly dirty surrounding can cause greater accumulation of dirt on the unit's optics.

- Clean with soft cloth and use normal glass to clean liquid.
- Always dry the parts carefully.
- Clean the external optics at least every 20 days. Clean the internal optics at least every 30 days.

Declaration of Conformity

We declare that our products (lighting equipments) comply with the following specification and bears CE mark in accordance with the provision of the Electromagnetic Compatibility (EMC) Directive 2014/30/EU.

EN 55032: 2015; EN 61000-3-2: 2014;
EN 61000-3-3: 2013; EN 55103-2: 2009.

&

Harmonized Standard

EN 60598-2-17: 1989+A2: 1991; EN 60598-1: 2015; EN 62471: 2008;
EN 62493: 2015; EN 62031: 2008+A1: 2013+A2: 2015.
Safety of household and similar electrical appliances
Part 1: General requirements

Innovation, Quality, Performance