

# ELLIPSOIDAL COLOR

E-200/E-200 MC



LED Theater

## Specifications

Light Source: 1x200W cool/warm white LED (E-200)  
1x200W 5 in 1 LED (E-200 MC)  
Color Temperature: 3200±150K (WW)  
5600±300K (CW)

## Control

DMX Channel: 1/2 channels (E-200)  
5/9 channels (E-200 MC)  
Control Mode: DMX, Manual, Master/Slave  
Firmware Upgrade: Update via DMX link

## Construction

Display: LCD display  
Data In/Out: 3-pin and 5-pin XLR  
Power In/Out: PowerCon in/out  
Protection Rating: IP20

## Photometrics Diagram(E-200)

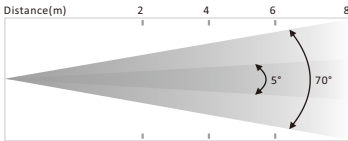

5 °Lux	83850	20963	9317	5241
11°Lux	31734	7933	3526	1983
14°Lux	18550	4638	2061	1159
19°Lux	10240	2560	1138	640
26°Lux	5472	1368	608	342
36°Lux	3411	852	379	213
50°Lux	1475	369	164	92
70°Lux	775	194	86	48

## Dimensions(mm)

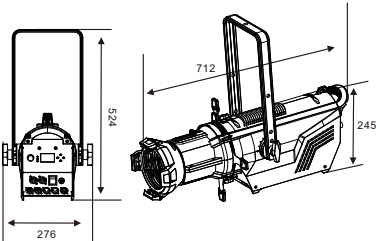

## Optical

CRI: WW≥86,CW≥86  
CQS:WW≥88,CW≥88  
TLCI:WW≥90,CW≥90

## Electrical and Physical

Power Voltage: AC 100~240V, 50/60Hz  
Power Consumption: 210W  
Dimensions: 712x276x245mm  
Weight: 10Kg

## Features

Excellent white color/five colors(Red,Green,Blue,LightGreen, Amber) smooth output  
Distinct imaging, multiple geometric figures  
Lens Options: 5° /11° /14° /19° /26° /36° /50° /70° (E-200)  
Lens Options: 14°/19°/26°/36°/50°/70°(E-200 MC)  
Framing module 1: for beam angle 5°/11°/14°/19°/26°(E-200)  
Framing module 2: for beam angle 36°/50°/70°(E-200)  
Electronic linear zoom system, 0°~100% smooth dimming  
Various strobe speeds  
Excellent thermal design, long LED life  
Low noise under 25dB@1m



Gobo slot  
Gobo size: Ø90mm  
Image size: Ø75mm

